

SUBJECT TO SITE SURVEY, CONFIRMATION OF LEGAL BOUNDARIES, SITE CONSTRAINTS & HIGHWAYS

THE HARRIS GROUP LTD DOES NOT ACCEPT LIABILITY FOR ANY DEVIATION TO OUR DRAWINGS OR SPECIFICATION.

PROPOSED AMALGAMATED CAR PARK:

110 ALDI CUSTOMER PARKING SPACES INC 5 DDA, 10 PC & 4 ACTIVE EV & 8 FUTURE EV

NOTES:

REFER TO SOFT LANDSCAPE DESIGNERS DRAWINGS FOR FULL DETAILS OF PROPOSED TREES, PLANTING, ETC.

REFER TO ARBORICULTURAL ASSESSMENT FOR FULL DETAIL OF TREE ROOT PROTECTION

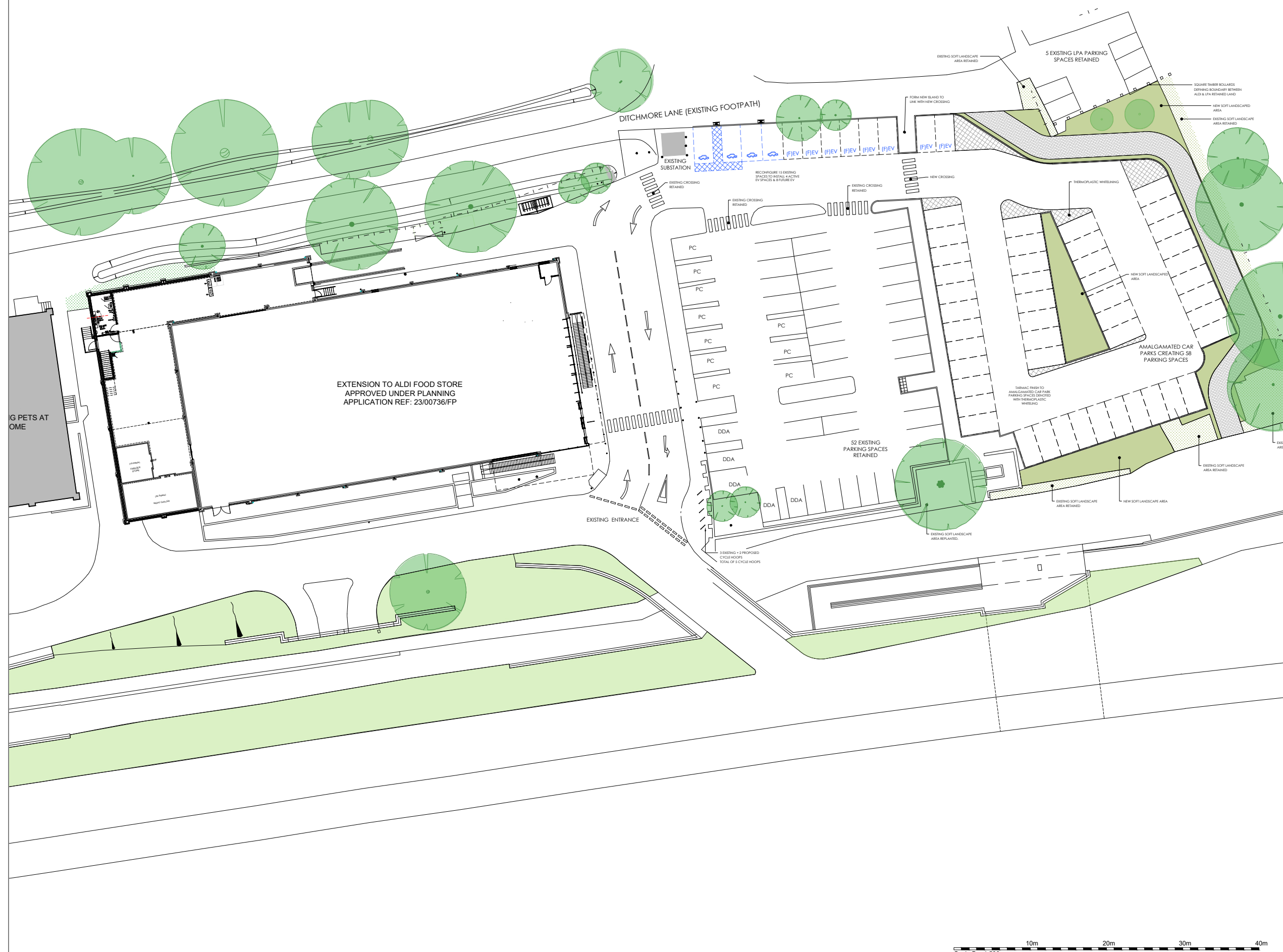

Rev	Date	Description	Rev By	Chk'd By
B	03.03.26	Foot / Cycle Way amended	NM	JPG
A	23.02.26	Foot / Cycle Way adjusted and pedestrian crossing incorporated.	NM	JPG



Project Title	PROPOSED CAR PARK AMALGAMATION & PEDESTRIAN ROUTE IMPROVEMENTS ALDI STORE FAIRLANDS WAY STEVENAGE SG1 1FZ			
Client	ALDI STORES LIMITED - CHELMSFORD			
Status	FEASIBILITY			
Scale	1:500	Drawing Size	A3	
Date	28.01.26	Drawn By	NM	Checked JPG
Drawing Title	PROPOSED CAR PARK SITE PLAN			
Job-Dwg No	1426-CHE-074	Rev	B	

- 2 St. Johns North, Wakefield, WF1 3QA t. 01924 291800
- Carvers Warehouse, 77 Dale Street, Manchester, M1 2HG t. 0161 2388555
- The Old Rectory, 79 High Street, Newport Pagnell, MK16 8AB t. 01908 211577
- 101 London Road, Reading, RG1 5BY t. 0118 9507700
- 10 Gees Court, St Christophers Place, London, W1U 1JJ t. 0207 4091215

